

FDO-A AND FDO-B SOLENOID KIT
K22-13028-1

INSTALLATION

Remove Existing Solenoid Assembly

1. Disconnect power to the operator.
 2. Remove the brake cover screws and remove brake cover (Figure 1).
 3. Remove solenoid cover screws and remove solenoid cover.
 4. Disconnect wires from the solenoid.
- NOTE:** For AC operators, the wires are blue and red. For DC operators, wires are black and red.
5. Remove the cotterpin that secures the plunger to the chain link (Figure 1).
 6. Remove the solenoid screws and remove the solenoid assembly.

Install New Solenoid Assembly

1. Secure the solenoid assembly to the brake plate with the hex screws provided (Figure 2). Do not securely tighten.
2. Connect plunger to the chain link with the cotterpin provided. Once the cotterpin is inserted, bend and trim the cotterpin (Figure 3).



WARNING

To prevent possible **SERIOUS INJURY** or **DEATH**, disconnect electric power to operator **BEFORE** installing.
ALL electrical connections **MUST** be made by a qualified individual.

CARTON INVENTORY

DESCRIPTION	QTY
Brake assembly with plunger	1
Cotterpin	1
Hex screws	4

Figure 1

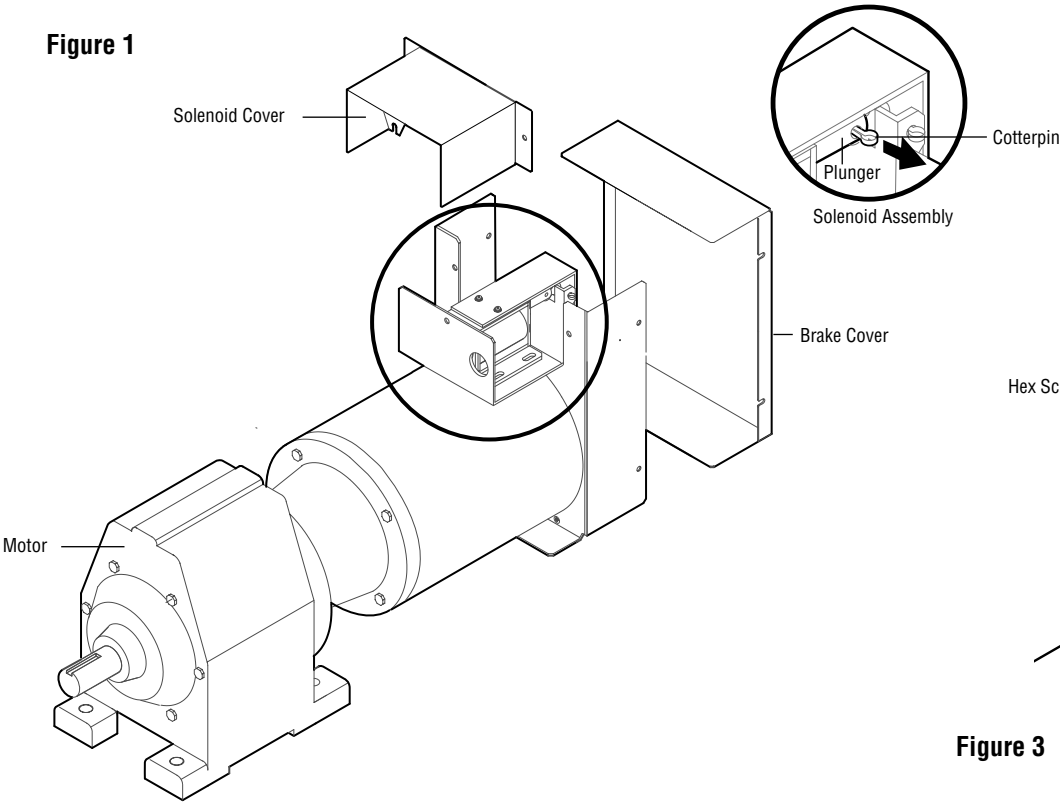

Figure 2

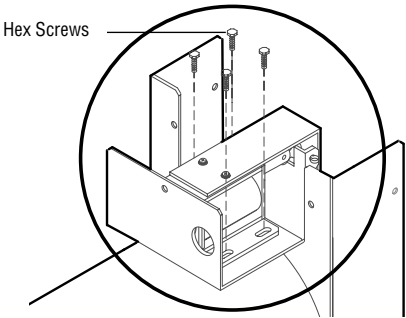
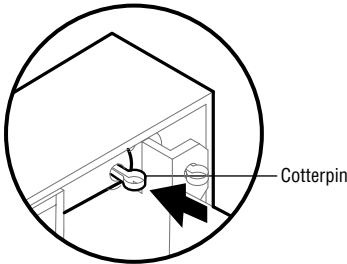

Figure 3



3. For AC Operators:

Slide the solenoid assembly to the brake as close as possible (Figure 4).

For DC Operators:

Slide the solenoid assembly to the motor as close as possible (Figure 4).

4. Securely tighten the hex screws.

Figure 4

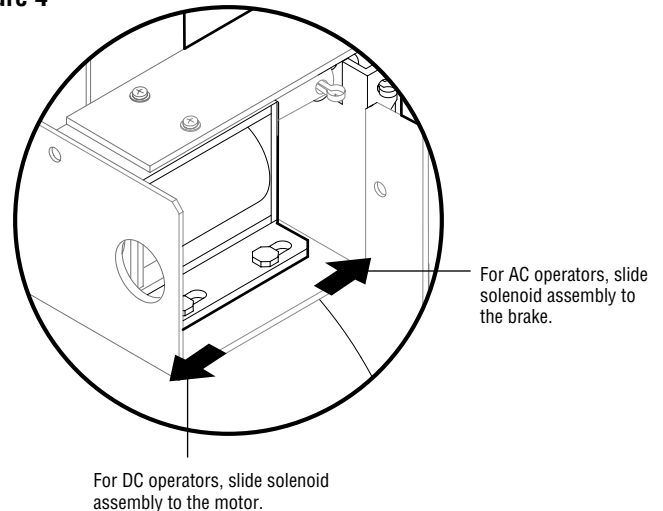

WIRING

For AC Operators:

1. Connect the blue wire to the negative terminal (-) (Figure 5).
2. Connect the red wire to the positive terminal (+) (Figure 5).

For DC Operators:

1. Connect the black wire to the negative terminal (-) (Figure 6).
2. Connect the red wire to the positive terminal (+) (Figure 6).

1. Reattach the solenoid cover and securely tighten with the existing screws.
2. Reattach brake cover and securely tighten with the existing screws.
3. Reconnect power to the operator.

Figure 5

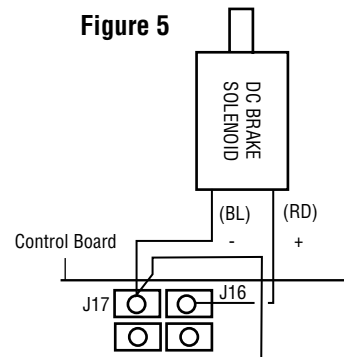

Figure 6

